



EAGLE
LIGHTING

A Fagerhult Group Company

Custodial Lighting

Product Catalogue - Eagle Lighting

Global reach, local expertise

Eagle Lighting aims to create safer, healthier environments with a focus on quality lighting, sustainability, and innovation, benefiting both people and the planet.

As a part of the Fagerhult Group, Eagle Lighting has over 50 years of experience in providing lighting solutions focused on human well-being. Our custodial range includes premium, locally manufactured products from our Melbourne factory and internationally sourced products from our UK-based sister company, Designplan. The range is specifically engineered to meet the stringent standards for custodial environments in Australia and New Zealand, prioritizing performance, safety, user comfort, and wellness.

Designplan is a global leader in custodial lighting, supplying luminaires tailored to the unique needs of custodial environments worldwide. We

combine products from Designplan, Fagerhult, and our own brand to offer low-maintenance, reliable solutions, incorporating the latest LED technology. These solutions ensure personal safety, impact resistance, and protection ratings crucial for demanding environments.

Our local expertise provides customised and reliable lighting solutions, addressing both current and future challenges. Our local manufacturing capability, technical knowledge and collaborative approach distinguish us as a trusted industry leader in the Australia and New Zealand market. We can provide quick turnaround projects delivering energy-efficient, sustainable, and easy-to-control lighting engineered solutions with our users in mind, such as contractors, facility managers, and end-users alike.



A Fagerhult Group Company



A Fagerhult Group Company

Innovative solutions for custodial projects

Eagle Lighting's custodial range is globally sourced to provide the most innovative solutions, incorporating the latest technology tailored for the local market. This approach goes beyond just product — it leverages the global expertise of the Fagerhult Group, ensuring that Eagle Lighting meets the highest standards in custodial projects.



Unmatched excellence



QUALITY

- Quality assurance through global sourcing network
- Circadian rhythms to enhance wellbeing
- Industry-leading testing standards



INNOVATION

- In-house Research and Development focuses on new product development, LED upgrades, Smart lighting technology enhancements
- Knowledge sharing and innovation through the Fagerhult Group worldwide connections

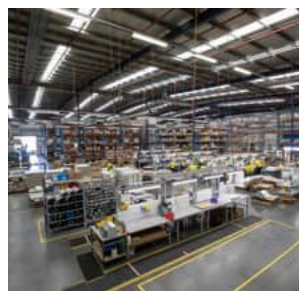

CUSTOMISATION

- Local manufacturing facility and accredited photometric laboratory
- Local Engineering team to ensure fast response times
- Flexibility in tailoring product and controls solutions
- Retrofit upgrade solutions



SAFETY

- IK tested product range
- IP tested product range
- Market-leading ligature-resistant product design
- Superior LED luminaire performance
- Registered EESS responsible supplier

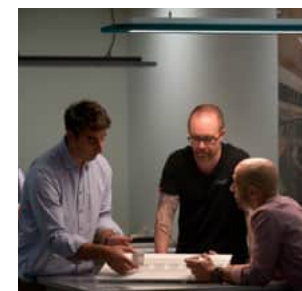

COLLABORATION

- In-house Lighting Design team
- In-house Technical expertise and knowledge
- Electrical Wholesaler and electrical contractor national network



LEAD TIMES

- Local team of experts available for site visits across Australia
- Short lead times due to Melbourne manufacturing and local warehousing of UK and SWE products
- Work to project planning and establish forecast requirements

Comprehensive testing you can trust

Eagle Lighting is a registered Responsible Supplier with the EESS, with all products listed in the ERAC database. We follow strict compliance for RCM labelling, ensuring electrical safety, EMC standards, and essential safety requirements for all luminaires and key components.

Our NATA-accredited photometric lab in Melbourne supports product development, third-party verification, and rapid market adaptation. We conduct accurate thermal testing and lifetime calculations per AS/NZS 60598.1, ensuring transparency and reliability.

Eagle Lighting products undergo extensive in-house testing to meet Australian and New Zealand standards. We also conduct IK (impact) and IP (water/dust ingress) testing, ensuring product durability and suitability for specific applications.

The product undergoes rigorous ligature-resistant testing to ensure it prevents potential self-harm or misuse, making it suitable for high risk areas such as prison cells and mental health units. LED luminaire performance ensures proper illumination for safety and navigation.

Designplan's robust luminaires feature high IP and IK ratings, tamperproof screws, and resistance to vandalism and water ingress, making them ideal for custodial environments particularly high security prison cells, mental health units, bathrooms and communal areas.

This product range exceeds the IK11 standard, with impact resistance up to 250 Joules energy (IK20), five times more than the IK11 standard. We follow EN60068-2-75 standards for durability, ensuring superior protection against vandalism.



IK TESTING:
Measuring impact resistance

The IK rating is an international standard that indicates how resistant a product is to impact. The standard BS EN 62262 relates to IK ratings, to identify the degree of protection provided by enclosures for electrical equipment against external mechanical impacts.



LIGATURE RESISTANCE TESTING:
Ensuring safety against self-harm

Ligature resistance testing evaluates luminaires for safety in high-risk areas, like prisons or secure healthcare facilities. The testing ensures the fixture has no recessed, moving or protruding parts, eliminating attachment points that could be used for self-harm.

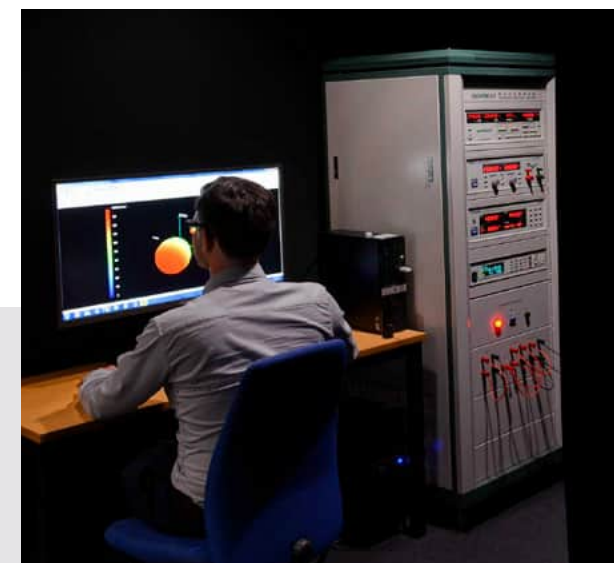

PHOTOMETRIC TESTING:
To measure light performance

As an independent benchmark for technical competence, receiving National Association of Testing Authorities (NATA) accreditation of our photometric laboratory in Melbourne demonstrates our commitment to quality, safety and the reliability of our products and services.

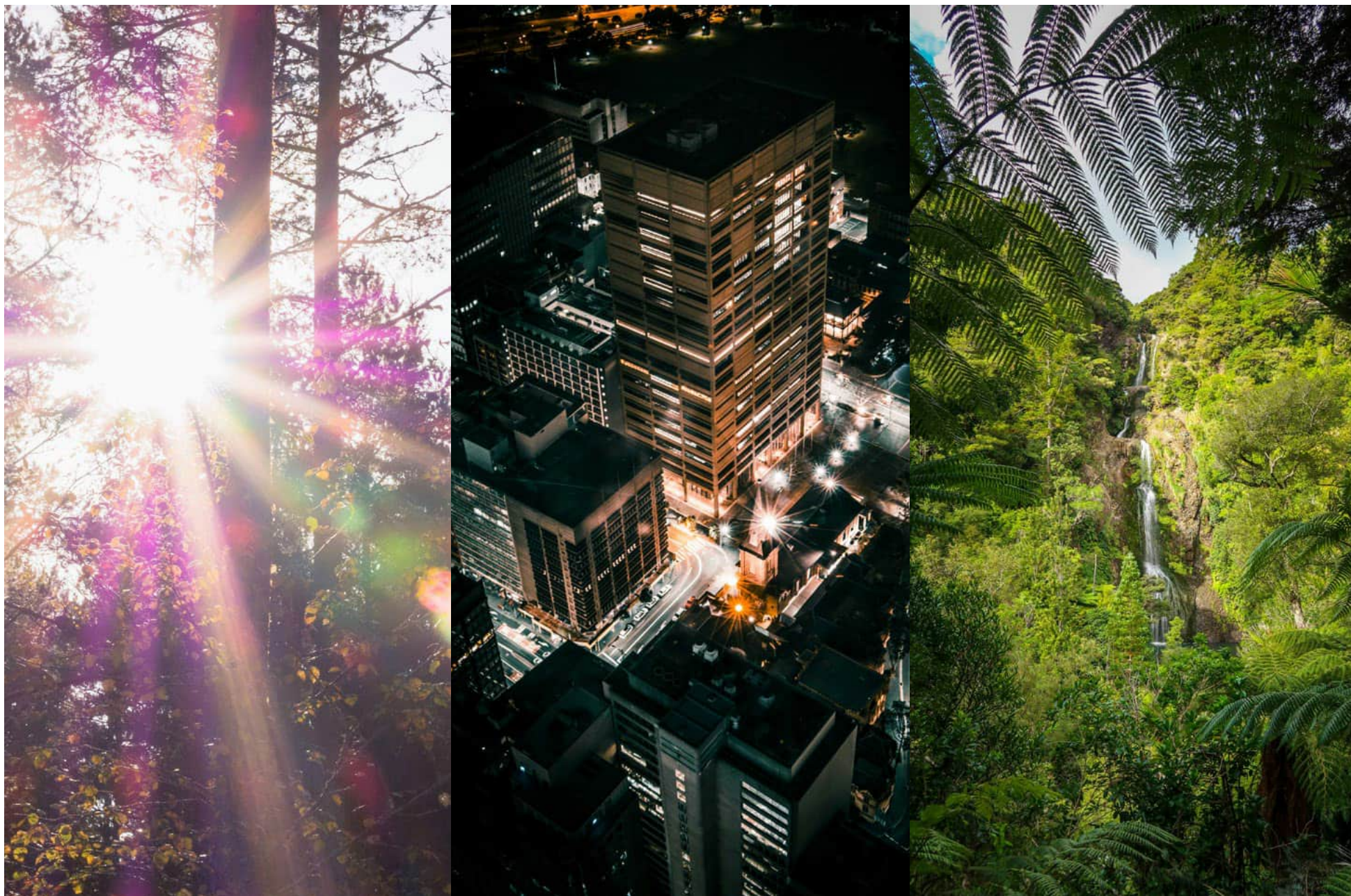

Sustainability

The Fagerhult Group has committed to be net zero no later than 2045. This target has been validated and approved by the Science Based Targets initiative (SBTi). Based on the knowledge of our products' opportunities and impact on our planet, we have identified long-term targets in four priority action areas: Circular solutions, Energy Efficiency, Pure Materials and Conscious production.

To achieve this target, Eagle Lighting has embarked on a number of initiatives including: increased use of recycled base materials; reduction in energy use in our operations; research and innovation in LEDs design and development; and the development of Smart lighting in luminaires to reduce our products life-time environmental impact.

FAGERHULT



Ease of installation

Drawing on our close collaboration with installers, we have focused on key design priorities: reducing luminaire weight, simplifying wiring, and ensuring ease of installation. By addressing these needs, we provide installers with a streamlined installation process, the ability to upgrade products quickly and easily, and reduced maintenance over the product's lifespan.

RETROFITTING

Eagle Lighting offers significant lifetime value of products through retrofitting existing light fittings by replacing old components with new LEDs, a process also known as gear tray replacement. This approach makes upgrading old fluorescent gear trays with LED solutions a cost-effective, quick, and often less disruptive option, especially in custodial settings where access is limited.

Our team of experts are skilled and experienced in the process of assessment, lighting removal, engineering, lighting design, testing and reporting to provide solutions that suit a wide range of existing lighting installations.





UPG (UPGRADEABLE)

Our custodial products are all upgradeable – they come with a demountable gear tray and can be upgraded in situ as technology changes, in as little as 46 seconds.

ANTI-PICK MASTIC

It is possible to apply anti-pick mastic to a number of products in our range and still allow for maintenance in-situ without removing the mastic.

Completed custodial projects



Australia

Brisbane Youth Detention Centre
Southern Queensland Correctional
Woodford Youth Detention Centre
Chisholm Rd Prison - Lara
Dame Phyllis Frost Centre
HM Prison Barwon
HM Prison Loddon
Villawood Immigration Detention Centre
Alice Springs Correctional Centre
Darwin Youth Justice Centre



New Zealand

Northland Region Corrections Facility
Mount Eden Corrections Facility
Waikeria Prison
Tongariro/Rangipo Prison
Manawatu Prison
Rimutaka Prison
Christchurch Men's Prison
Christchurch Women's Prison



Global

HMP Berwyn, UK
HMP Fosse Way, UK
HMP Belmarsh, UK
HMP Millsike, UK
HMP Liverpool, UK
HMP Elmley, UK
HMP Wormwood Scrubs, UK
Hammersmith Police Station, UK
Viru Prison, Estonia
JVA Bremen Prison, Germany



RGB and tuneable white (TW) lighting

RGB and Tuneable White (TW) lighting support mental health in custodial settings by aligning light exposure with circadian rhythms. Daytime blue-enriched light can improve alertness, sleep, and mood, while amber or red light at night avoids melatonin suppression linked to poor sleep and increased stress. Blue lighting was previously used to deter intravenous drug use by obscuring veins, but evidence for its effectiveness is weak, and its circadian disruption is well documented. Research shows that well-timed, spectrally appropriate lighting improves sleep and emotional stability via non-image-forming pathways such as ipRGCs.



Freely adjustable colours with RGBW solutions

Speak to your Eagle Lighting Sales Representative about which luminaires are compatible with Tuneable White and RGB lighting

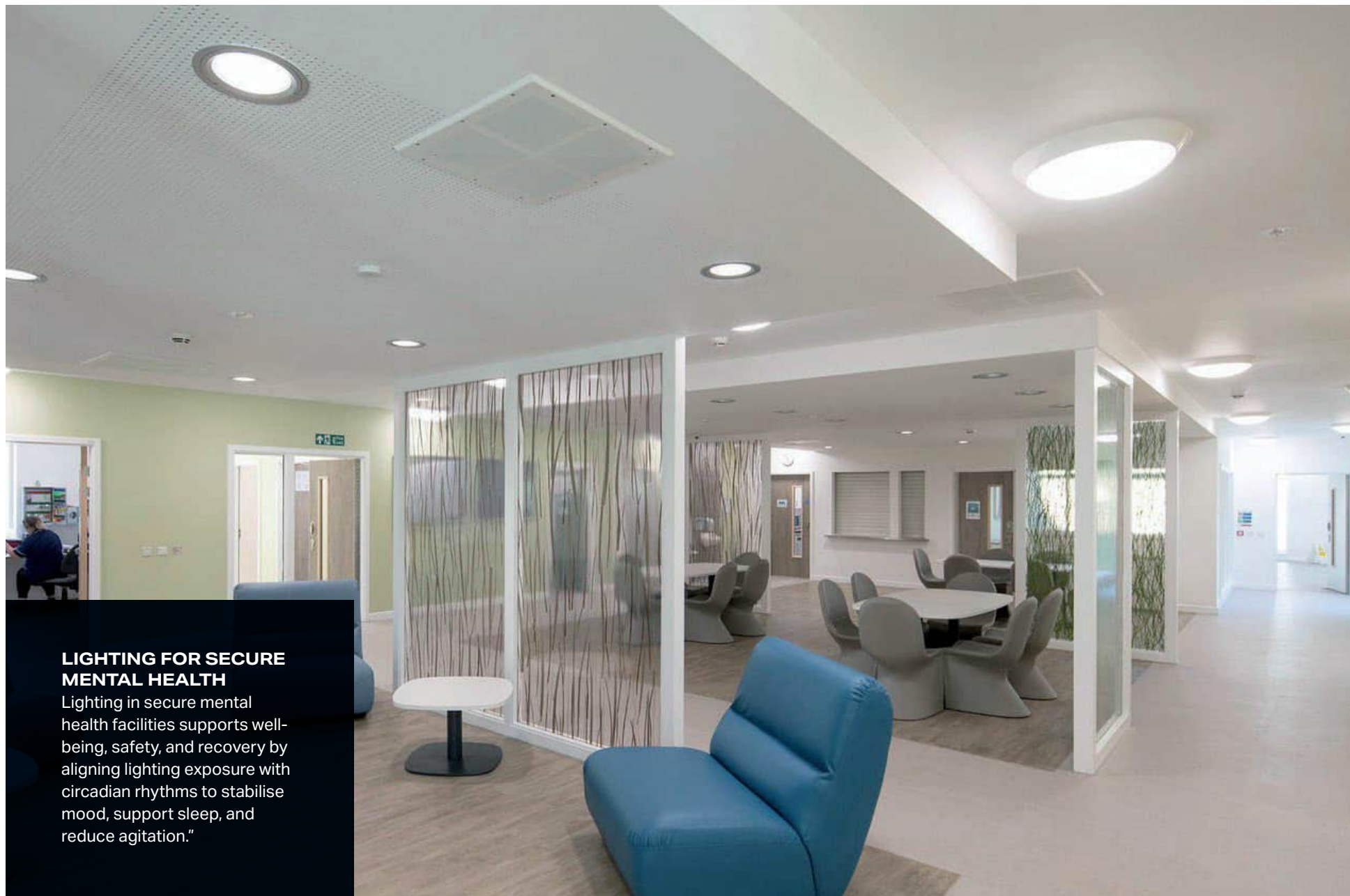

LIGHTING FOR SECURE MENTAL HEALTH

Lighting in secure mental health facilities supports well-being, safety, and recovery by aligning lighting exposure with circadian rhythms to stabilise mood, support sleep, and reduce agitation."

High security Prisoner cell

Ceiling Recessed

Arculus Square Recessed
IK 16 IP 65 UPG



Arculus Linear Recessed
IK 16 IP 65 UPG



Secure Room IP65
IK 10 IP 65 UPG



Protekt
IK 13 IP 65 UPG



Suitable for concrete

Wall

Basilica
IK 20 IP 66 UPG



Ceiling Surface Mounted

Abrams AL
IK 16 IP 65 UPG



Abby G2
IK 20 IP 65 UPG



Basilica
IK 20 IP 66 UPG



Vanguard LED
IK 10 IP 44 UPG



Secure Room IP65 SM
IK 10 IP 54 UPG



Corner Mount

Obex
IK 20 IP 65 UPG



Uni Cell
IK 16 IP 65 UPG



Recessed Downlight

DL86 SC
IK 16 IP 65 UPG



RDL AL G2
IK 14 IP 65 UPG



Reading Light incl. Dimmer Switch

DPR20 / S
IK 16 IP 65 UPG



Nite Cell Lamp
IK 10 IP 40 UPG



Please note: BS EN 62262 does not allocate codes above IK11. The IK codes above IK11 are extrapolated and assigned IK references by Designplan based on impact energy measure in Joules. For example Impact energy of 100 Joules is classed as IK14, 150 Joules is classed as IK16, and 250 Joules is classed as IK20. UPG = Upgradeable product



Uni Cell

By testing to the BS EN60068-2-75 standard using a drop hammer we have extrapolated the data from 50 Joules (IK11) up to 150 Joules of energy (IK16) for this product.

Please note: BS EN 62262 does not allocate codes above IK11. The IK codes above IK11 are extrapolated and assigned IK references by Designplan based on impact energy measure in Joules. For example Impact energy of 100 Joules is classed as IK14, 150 Joules is classed as IK16, and 250 Joules is classed as IK20. UPG = Upgradeable product

High security wet areas

Showers, bathrooms, ensuites

Ceiling Recessed

Quadratum Square
IK 14 IP 65 UPG



Secure Room IP65
IK 10 IP 65 UPG



Recessed Downlight

DL86 SC
IK 16 IP 65 UPG



RDL AL G2
IK 14 IP 65 UPG



Ceiling Surface Mounted

Monitor
IK 14 IP 54 UPG



Basilica
IK 20 IP 66 UPG



Secure Room IP65 SM
IK 10 IP 65 UPG



Corner Mount

Obex
IK 20 IP 65 UPG



Uni Cell
IK 16 IP 65 UPG



Wall

Basilica
IK 20 IP 65 UPG



IP TESTING

Please note: BS EN 62262 does not allocate codes above IK11. The IK codes above IK11 are extrapolated and assigned IK references by Designplan based on impact energy measure in Joules. For example Impact energy of 100 Joules is classed as IK14, 150 Joules is classed as IK16, and 250 Joules is classed as IK20. UPG = Upgradeable product

High security communal areas

Day rooms, library, learning spaces

Ceiling Recessed

Arculus Square Recessed
IK 16 IP 65 UPG



Arculus Linear Recessed
IK 16 IP 65 UPG



Secure Room IP65
IK 10 IP 65 UPG



High Bay

Hero
IK 10 IP 65 UPG



Reading Light incl. Dimmer Switch

DPR20 / S
IK 16 IP 65 UPG



Nite Cell Lamp
IK 10 IP 40 UPG



Ceiling Surface Mounted

Parkalux
IK 14 IP 54 UPG



Linilux
IK 12 IP 54 UPG



Basilica
IK 20 IP 66 UPG



Vanguard LED
IK 10 IP 44 UPG



Curve VR
IK 14 IP 54 UPG



Secure Room IP65 SM
IK 10 IP 65 UPG



Corner Mount

Obex
IK 20 IP 65 UPG



Uni Cell
IK 16 IP 65 UPG



Wall

Basilica
IK 20 IP 66 UPG



Recessed Downlight

DL86 AL
IK 14 IP 65 UPG



RDL AL G2
IK 14 IP 65 UPG



Please note: BS EN 62262 does not allocate codes above IK11. The IK codes above IK11 are extrapolated and assigned IK references by Designplan based on impact energy measure in Joules. For example Impact energy of 100 Joules is classed as IK14, 150 Joules is classed as IK16, and 250 Joules is classed as IK20. UPG = Upgradeable product

High security shared spaces

Corridors, halls, entrances

Ceiling Recessed

Quadratum Square
IK 14 IP 54 UPG



Secure Room IP65 EL
IK 10 IP 65 UPG



Recessed Downlight

DL86 AL
IK 14 IP 65 UPG



RDL AL G2
IK 14 IP 65 UPG



Ceiling Surface Mounted

Linilux
IK 12 IP 54 UPG



Basilica
IK 20 IP 66 UPG



Vanguard LED
IK 10 IP 44 UPG



Secure Room IP65 SM
IK 10 IP 65 UPG



Corner Mount

Obex
IK 20 IP 65 UPG



Uni Cell
IK 16 IP 65 UPG



Wall

Basilica
IK 20 IP 66 UPG



Tuscan
IK 16 IP 65 UPG



Please note: BS EN 62262 does not allocate codes above IK11. The IK codes above IK11 are extrapolated and assigned IK references by Designplan based on impact energy measure in Joules. For example Impact energy of 100 Joules is classed as IK14, 150 Joules is classed as IK16, and 250 Joules is classed as IK20. UPG = Upgradeable product

High security exterior

Courtyards, covered areas, walkways

Ceiling Surface Mounted

Tuscan
IK 16 IP 65 UPG



Parkalux
IK 14 IP 54 UPG



Wall

Tuscan Angled
IK 16 IP 65 UPG



Quadrant
IK 14 IP 54 UPG



Basilica
IK 20 IP 66 UPG



Wall continued

Zelos Skislope
IK 16 IP 66 UPG



Trackline Bulkhead
IK 14 IP 65 UPG



Hero
IK 10 IP 66 UPG



PARKALUX

Please note: BS EN 62262 does not allocate codes above IK11. The IK codes above IK11 are extrapolated and assigned IK references by Designplan based on impact energy measure in Joules. For example Impact energy of 100 Joules is classed as IK14, 150 Joules is classed as IK16, and 250 Joules is classed as IK20. UPG = Upgradeable product

Medium security Prisoner cell

Ceiling Recessed

Quadratum Square
IK 14 IP 65 UPG



Protekt
IK 13 IP 65 UPG



Corner Mount

Linilux Angled
IK 12 IP 65 UPG



Ceiling Surface Mounted

Monitor II
IK 14 IP 54 UPG



Basilica
IK 20 IP 66 UPG



Vanguard LED
IK 10 IP 44 UPG



Secure Room IP65 SM
IK 10 IP 65 UPG



Wall

Basilica
IK 20 IP 66 UPG



Recessed Downlight

DL86 SC
IK 16 IP 65 UPG



RDL AL G2
IK 14 IP 65 UPG



Reading Light Incl. Dimmer Switch

DPR20 / S
IK 16 IP 65 UPG



Nite Cell Lamp
IK 10 IP 40 UPG



Please note: BS EN 62262 does not allocate codes above IK11. The IK codes above IK11 are extrapolated and assigned IK references by Designplan based on impact energy measure in Joules. For example Impact energy of 100 Joules is classed as IK14, 150 Joules is classed as IK16, and 250 Joules is classed as IK20. UPG = Upgradeable product

Medium security wet areas

Showers, bathrooms, ensuites

Ceiling Recessed

Quadratum Square
IK 14 IP 65 UPG



Secure Room IP65
IK 10 IP 65 UPG



Wall

Basilica
IK 20 IP 66 UPG



Ceiling Surface Mounted

Monitor
IK 14 IP 54 UPG



Basilica
IK 20 IP 66 UPG



Secure Room IP65 SM
IK 10 IP 65 UPG



Corner Mount

Linilux Angled
IK 12 IP 54 UPG



Recessed Downlight

DL86 SC
IK 20 IP 65 UPG



RDL AL G2
IK 14 IP 65 UPG



Please note: BS EN 62262 does not allocate codes above IK11. The IK codes above IK11 are extrapolated and assigned IK references by Designplan based on impact energy measure in Joules. For example Impact energy of 100 Joules is classed as IK14, 150 Joules is classed as IK16, and 250 Joules is classed as IK20. UPG = Upgradeable product

Medium security communal areas

Day rooms, library, learning spaces

Ceiling Recessed

Quadratum Square
IK 14 IP 65 UPG



Secure Room IP65
IK 10 IP 65 UPG



Wall

Basilica
IK 20 IP 66 UPG



Discovery + Ligature-resistant
Casting
IK 10 IP 55 UPG



Ceiling Surface Mounted

Linilux
IK 12 IP 54 UPG



Curve VR
IK 14 IP 54 UPG



Basilica
IK 20 IP 66 UPG



Vanguard LED
IK 10 IP 44 UPG



Secure Room IP65 SM
IK 10 IP 65 UPG



Corner Mount

Linilux Angled
IK 12 IP 65 UPG



Recessed Downlight

DL86 AL
IK 14 IP 65 UPG



RDL AL G2
IK 14 IP 65 UPG



Pleiad + Ligure Resistant Kit
IK 10 IP 64 UPG



Please note: BS EN 62262 does not allocate codes above IK11. The IK codes above IK11 are extrapolated and assigned IK references by Designplan based on impact energy measure in Joules. For example Impact energy of 100 Joules is classed as IK14, 150 Joules is classed as IK16, and 250 Joules is classed as IK20. UPG = Upgradeable product



Curve VR

Incorporating a removable gear tray ensures Curve VR is quick and easy to maintain, whilst enabling cost effective technology upgrades to the latest energy efficient LED light engines.

Please note: BS EN 62262 does not allocate codes above IK11. The IK codes above IK11 are extrapolated and assigned IK references by Designplan based on impact energy measure in Joules. For example Impact energy of 100 Joules is classed as IK14, 150 Joules is classed as IK16, and 250 Joules is classed as IK20. UPG = Upgradeable product

Medium security shared spaces

Corridors, halls, entrances

Ceiling Recessed

Quadratum Square
IK 14 IP 65 UPG



Secure Room IP65
IK 10 IP 65 UPG



Ceiling Surface Mounted

Linilux
IK 12 IP 54 UPG



Basilica
IK 20 IP 66 UPG



Curve VR
IK 14 IP 54 UPG



Corner Mount

Linilux Angled
IK 12 IP 54 UPG



Recessed Downlight

DL86 AL
IK 14 IP 65 UPG



RDL AL G2
IK 14 IP 65 UPG



BASILICA

Please note: BS EN 62262 does not allocate codes above IK11. The IK codes above IK11 are extrapolated and assigned IK references by Designplan based on impact energy measure in Joules. For example Impact energy of 100 Joules is classed as IK14, 150 Joules is classed as IK16, and 250 Joules is classed as IK20. UPG = Upgradeable product

Medium security

Prisoner recreational, sport, workshops

Ceiling Recessed

Quadratum Square
IK 14 IP 65 UPG



Secure Room IP65
IK 10 IP 65 UPG



Downlight

DL86 AL
IK 14 IP 65 UPG



RDL AL G2
IK 14 IP 65 UPG



Ceiling Surface Mounted

Linilux
IK 12 IP 54 UPG



Basilica
IK 20 IP 66 UPG



Tuscan
IK 16 IP 65 UPG



Ceiling Surface Mounted continued

Gemco
IK 14 IP 65 UPG



Vanguard LED
IK 10 IP 44 UPG



Secure Room IP65 SM
IK 10 IP 65 UPG

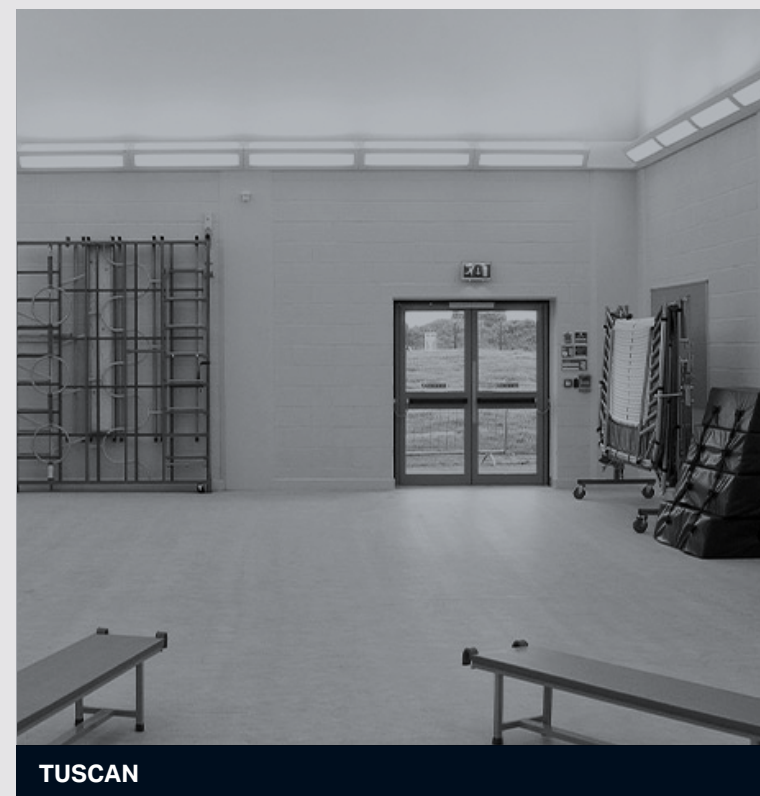

TUSCAN

Please note: BS EN 62262 does not allocate codes above IK11. The IK codes above IK11 are extrapolated and assigned IK references by Designplan based on impact energy measure in Joules. For example Impact energy of 100 Joules is classed as IK14, 150 Joules is classed as IK16, and 250 Joules is classed as IK20. UPG = Upgradeable product

Non-prisoner area

Reception, administration, staff rooms,
corridors, kitchens

Ceiling Recessed

Aureled (+Plaster Kit)



OmniPOD



Vertex (+Plaster Kit)



Ceiling Suspended

Educo + Suspension



Sweep



OmniPOD Pendant



Ceiling Surface Mounted

Aureled (+SM Kit)



Educo



Discovery Evo



Vetex (+SM Kit)



RapidLED



Ceiling Surface Mounted (continued)

Monitor



Densus



Downlight

Pleiad 165



DL86 AL



RDL AL G2



Cirkel





OmniPOD



Sweep



Aureled – Surface Mounted

Non-Prisoner exterior area

Walkways, covered areas, carparks

Wall Mounted

Parkalux Angled



Zelos Skislope



Trackline Bulkhead



Zelos Bollard



Simes Bollard



Wall Mounted

Densus



Pole Mounted

Fagerhult Evolume



Surface Mounted

Parkalux



Discovery Evo + Outdoor Casting



DENSUS

Emergency

Emergency Ceiling Surface Mounted

Linilux
IK 12 IP 54 UPG



Basilica
IK 20 IP 66 UPG



Tuscan
IK 16 IP 65 UPG



Gemco+EM
IK 14 IP 65 UPG



Vanguard LED+EM
IK 10 IP 44 UPG



Secure Room IP65+EM
IK 10 IP 65 UPG



Emergency Exit Lights

Ultrablade PRO
Clevertronics



Gateline emergency light
IK 14 IP 65 UPG



Emergency Ceiling Recessed

Quadratum Square
IK 14 IP 65 UPG



Secure Room IP65 EL
IK 10 IP 65 UPG



TUSCAN

Please note: BS EN 62262 does not allocate codes above IK11. The IK codes above IK11 are extrapolated and assigned IK references by Designplan based on impact energy measure in Joules. For example Impact energy of 100 Joules is classed as IK14, 150 Joules is classed as IK16, and 250 Joules is classed as IK20. UPG = Upgradeable product



eaglelighting.com.au
info@eaglelighting.com.au
Contact us today

AUSTRALIA

Victoria
Head Office
17-19 Jets Court
Melbourne Airport 3045
(03) 9344 7444

New South Wales
Level 1
71-73 Alexander Street,
Crows Nest 2065
(02) 9420 5799

Queensland
53 Caswell Street
East Brisbane
QLD 4169
(07) 3891 0744

Australian Capital Territory
0411 889 406

Western Australian
(Distributor)
H.I. Lighting
111 Broadway
Bassendean
WA 6054
(08) 9377 1322

South Australia
(Distributor)
Buckford Illumination Group, Unit 3,
169 Goodwood Road
Millswood SA 5034
0448 064 412

Tasmania
(Distributor)
Southern Lighting
34 Federal Street
North Hobart
TAS 7000
(03) 6231 5599

NEW ZEALAND

Auckland
Citigroup Centre,
23 Custom St East
Auckland Central 1010
New Zealand
0800 324 374

Lower North Island
Wellington
021 597 900