

FAGERHULT SE - 566 80 Habo

Pleiad G4 Recessed

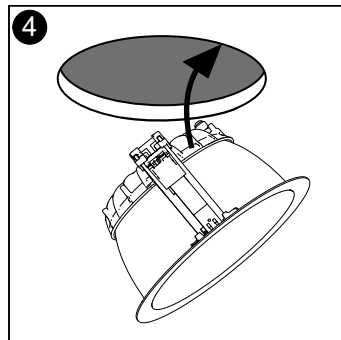

Installation Video:
<http://vimeo.com/311878671>

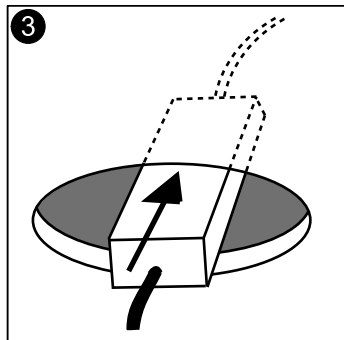
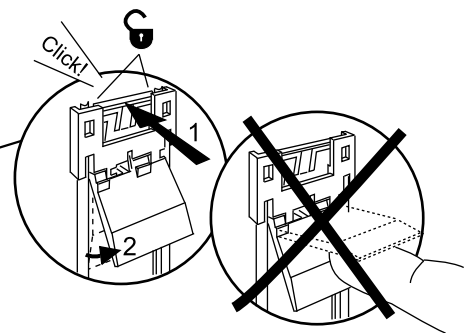
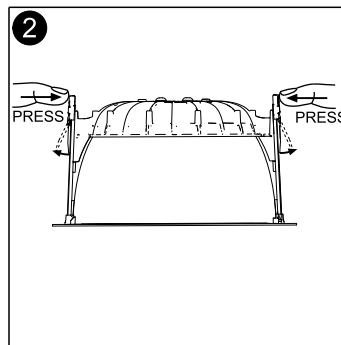
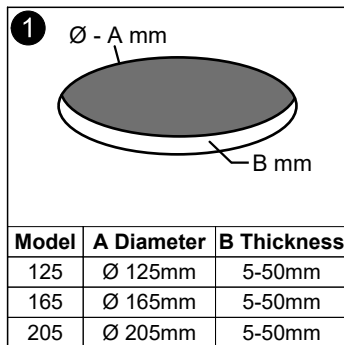
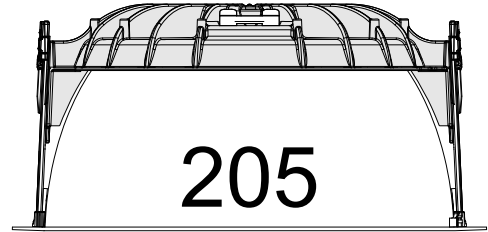
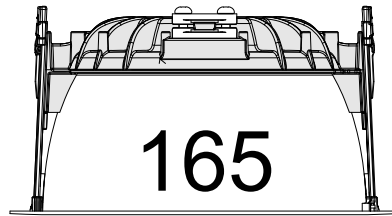
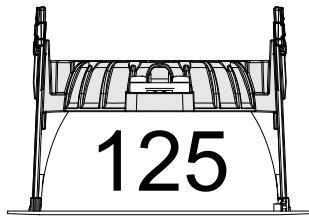
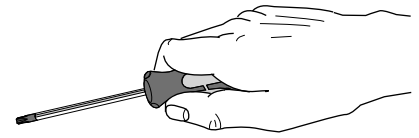
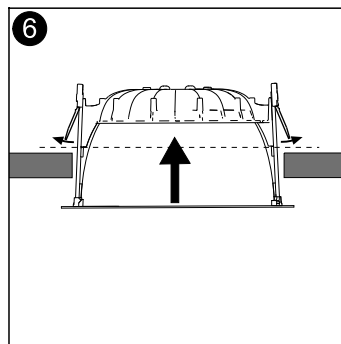
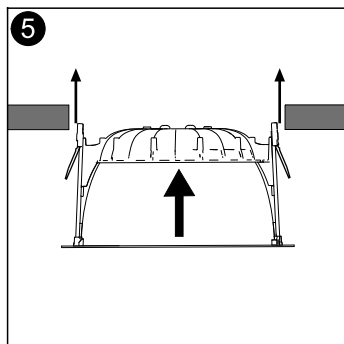
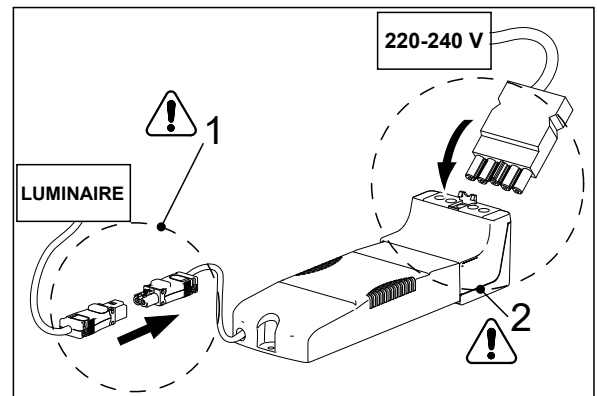

- (S)** Armaturdel **MÅSTE** anslutas innan nätspänning kopplas in!
- (GB)** The luminaire **MUST** be connected before plugging in the mains voltage!
- (D)** Die Leuchtenteil **MUSS** vor dem Einstecken der Netzspannung angeschlossen werden!

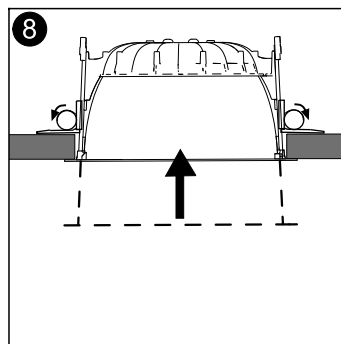
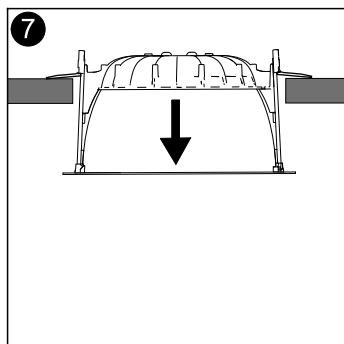

- (S)** Ljuskälla och drivdon ska enbart bytas ut av tillverkaren eller dess utsedda person.
- (GB)** The light source and control gear shall only be replaced by the manufacturer or its designated person.

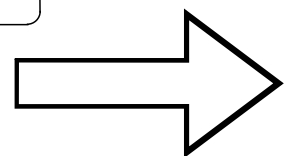

5421963 Utgåva/Edition 03

(S) Det är lämpligt att denna information överlämnas till användaren av anläggningen. **(GB)** It is appropriate that this information is passed on to the users of the installation.

FAGERHULT SE - 566 80 Habo

Pleiad G4 Recessed

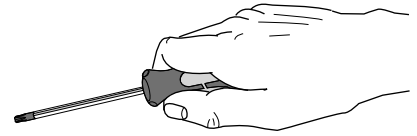

Removal Procedure

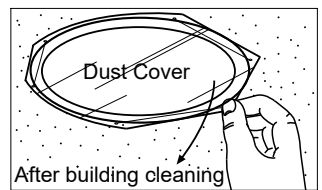
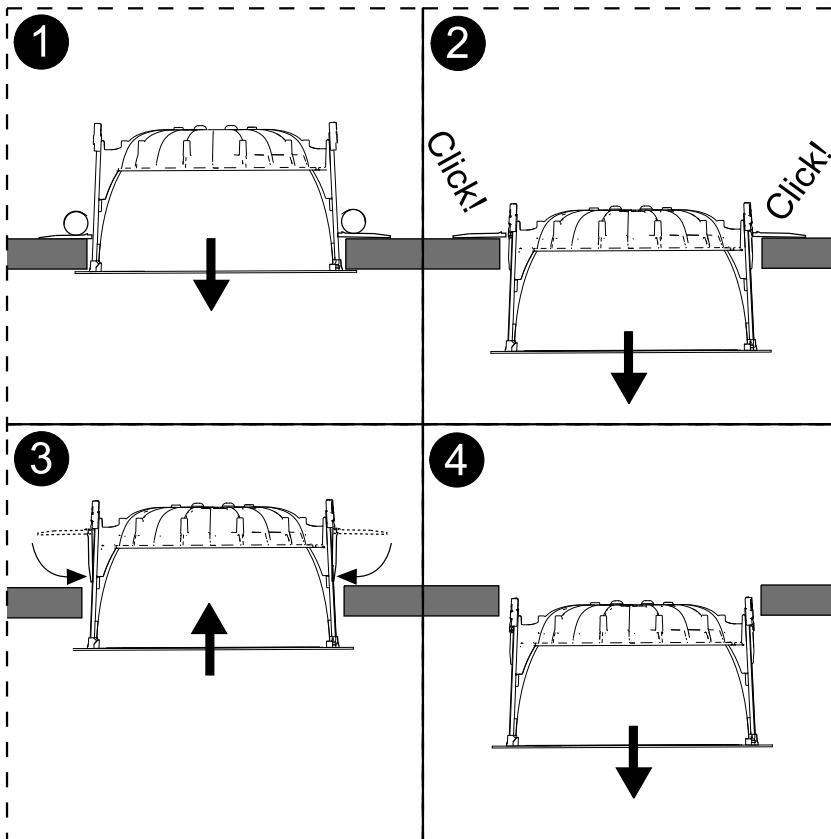

- (S)** För montering i ventilerat alternativt oventilerat utrymme.
- (GB)** For mounting in ventilated or unventilated space

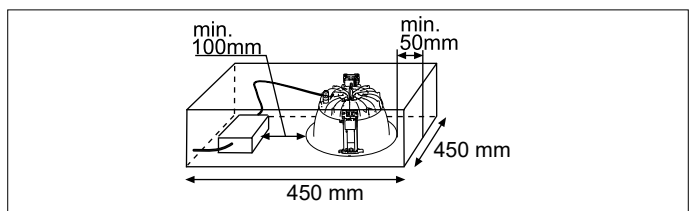
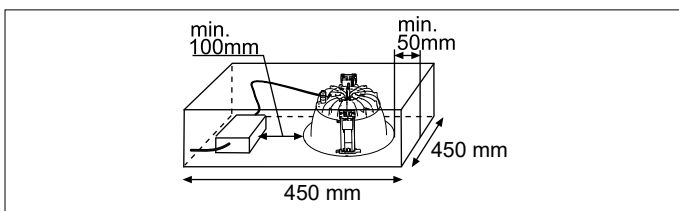

- (S)** Om armaturens kabel skulle skadas eller om armaturen inte fungerar som den ska, skall dessa komponenter kontrolleras/bytas av tillverkaren eller av tillverkaren utsedd person
- (GB)** If the luminaire cable is damaged or if the luminaire is not working properly, it shall exclusively be checked/replaced by the manufacturer or by the manufacturer designated person.

- (GB)** The light source and control gear shall only be replaced by the manufacturer or its designated person.

FAGERHULT SE - 566 80 Habo

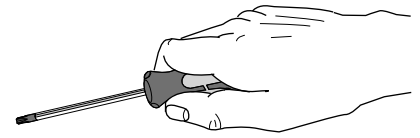

Pleiad G4 Recessed Dim to Warm

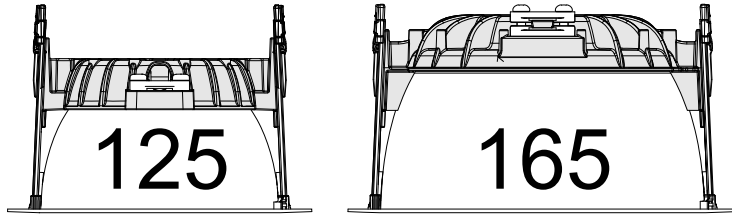

1 Ø - A mm
B mm

Model	A Diameter	B Thickness
125	Ø 125mm	5-50mm
165	Ø 165mm	5-50mm

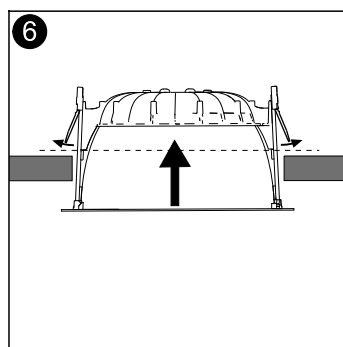
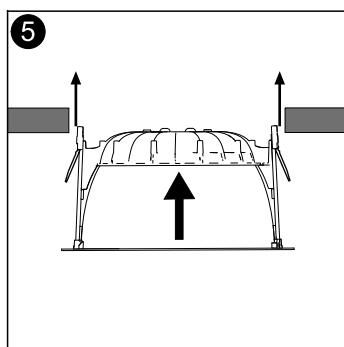
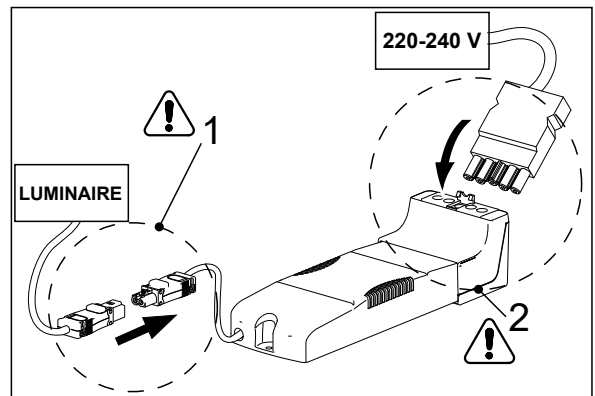
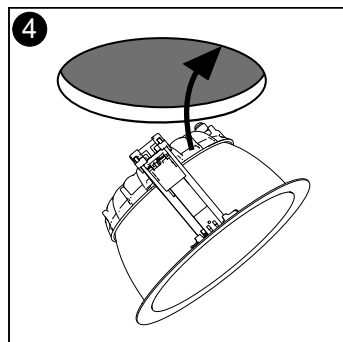
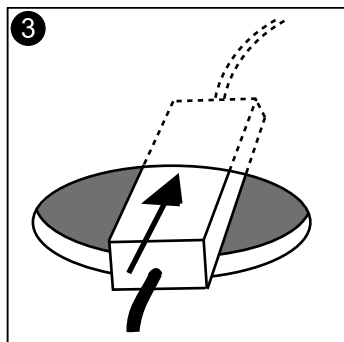
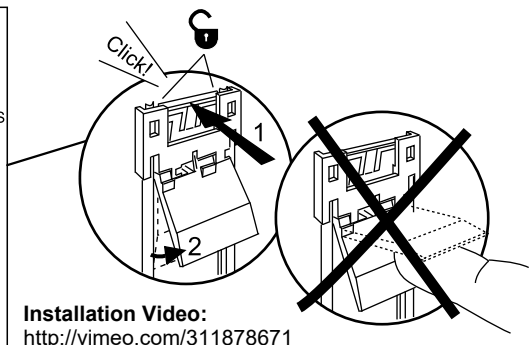
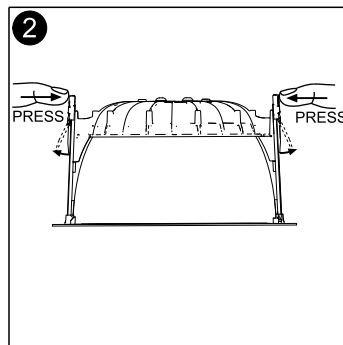

- S** Armaturdel **MÅSTE** anslutas innan nätspänning kopplas in!
- GB** The luminaire **MUST** be connected before plugging in the mains voltage!
- D** Die Leuchtenteil **MUSS** vor dem Einstecken der Netzspannung angeschlossen werden!

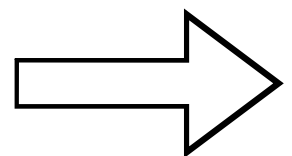
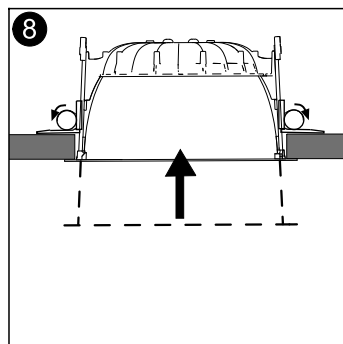
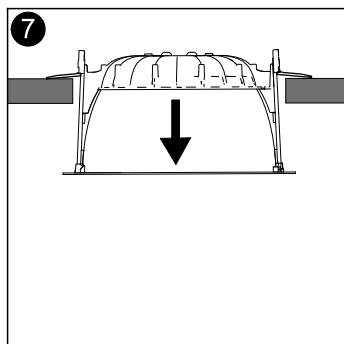

5435812 Utgåva/Edition 02

S Det är lämpligt att denna information överlämnas till användaren av anläggningen. **GB** It is appropriate that this information is passed on to the users of the installation.

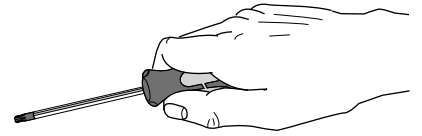

Pleiad G4 Recessed Dim to Warm

Removal Procedure

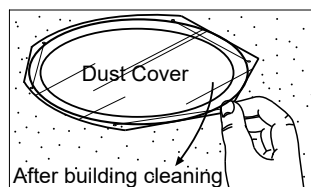
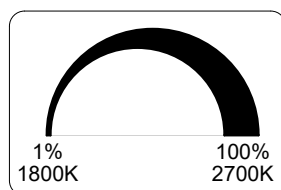
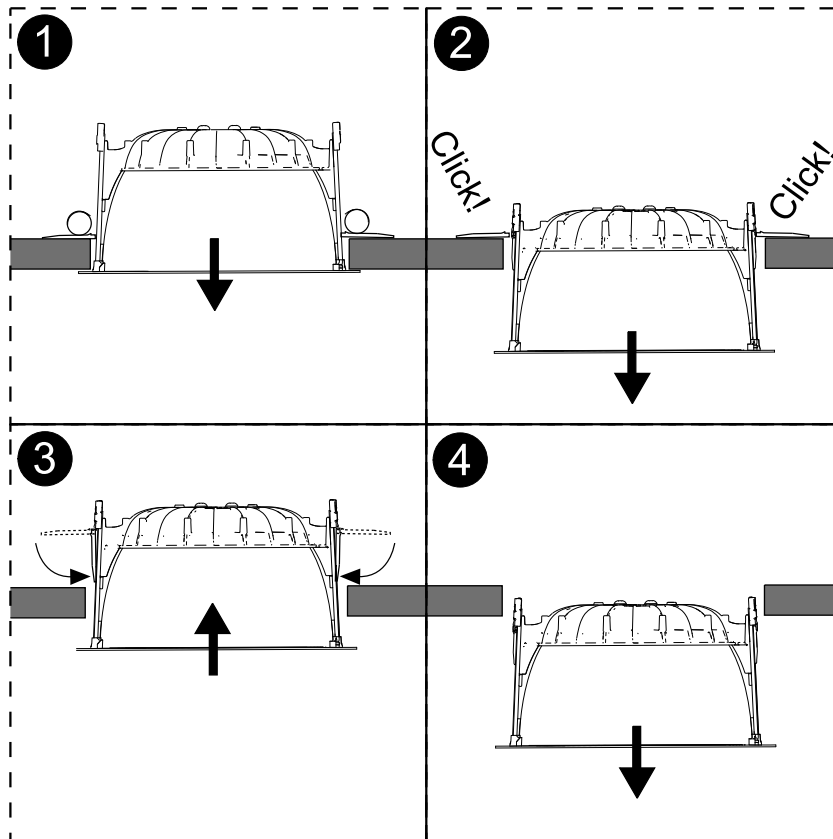

- S** För montering i ventilerat alternativt oventilerat utrymme.
- GB** For mounting in ventilated or unventilated space

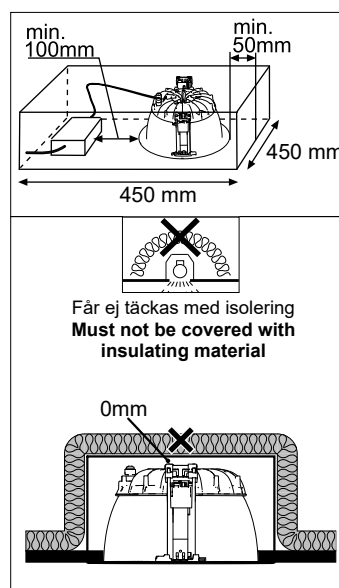

- S** Om armaturens kabel skulle skadas eller om armaturen inte fungerar som den ska, skall dessa komponenter kontrolleras/bytas av tillverkaren eller av tillverkaren utsedd person
- GB** If the luminaire cable is damaged or if the luminaire is not working properly, it shall exclusively be checked/replaced by the manufacturer or by the manufacturer designated person.

- S** Ljuskälla och drivdon ska enbart bytas ut av tillverkaren eller dess utsedda person.
- GB** The light source and control gear shall only be replaced by the manufacturer or its designated person.